

# H203D

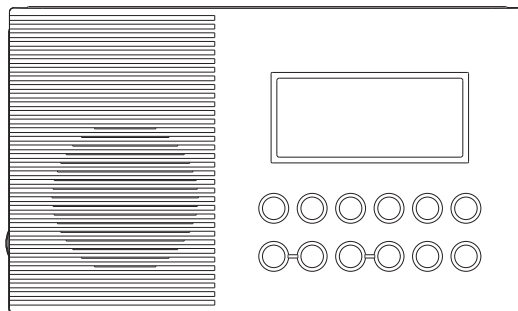

**GB**

Version 1

# Contents

<i>Installing batteries</i> .....	4
<i>Using the AC adapter (not supplied)</i> .....	5
<i>Setting the clock</i> .....	6-7
<i>Updating your radio - DAB</i> .....	8
<i>Selecting a station - DAB</i> .....	9
<i>Secondary services - DAB</i> .....	9
<i>Display modes - DAB</i> .....	10
<i>Finding new stations - DAB</i> .....	11
<i>Manual tuning - DAB</i> .....	12
<i>Dynamic range control - DAB</i> .....	13
<i>Manual tuning - FM</i> .....	14
<i>Auto tuning - FM</i> .....	15
<i>Scan sensitivity setting</i> .....	16
<i>Display modes - FM</i> .....	17
<i>Presetting stations - DAB &amp; FM</i> .....	17
<i>Recalling a preset - DAB &amp; FM</i> .....	18
<i>Sleep function- Auto off</i> .....	18
<i>Egg timer</i> .....	19
<i>Software version</i> .....	19
<i>System reset</i> .....	20
<i>Software upgrade</i> .....	21
<i>Emergency buzzer</i> .....	22
<i>Torch</i> .....	22
<i>Installing multi - purpose handle / bracket / carrying strap</i> .....	22-24
<i>Specifications</i> .....	25

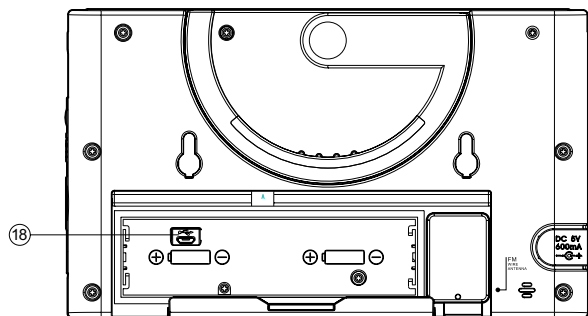
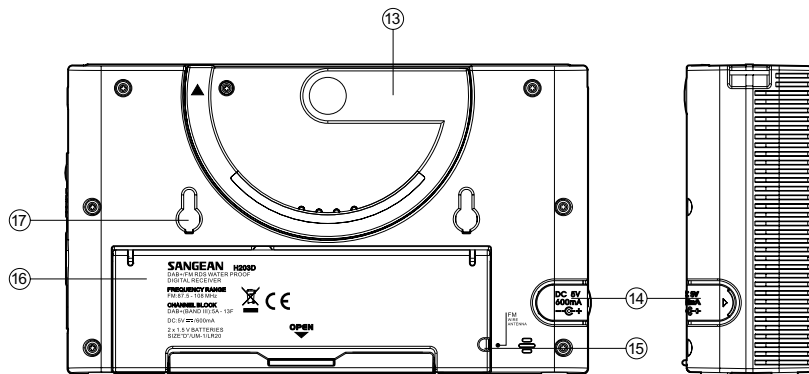
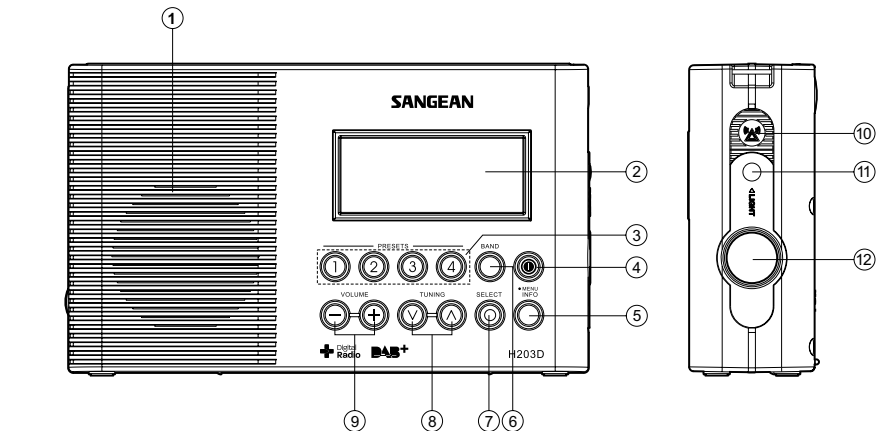

# Controls

GB

- ① Speaker
- ② LCD display
- ③ Station preset
- ④ Power button
- ⑤ Info / Menu button
- ⑥ Band button
- ⑦ Select button
- ⑧ Tuning up / down button
- ⑨ Volume up / down button
- ⑩ Emergency buzzer
- ⑪ Torch button
- ⑫ Torch
- ⑬ Multi purpose handle
- ⑭ DC IN socket
- ⑮ FM wire antenna compartment
- ⑯ Battery compartment
- ⑰ Bracket holder
- ⑱ USB socket for software upgrade

## LCD Display

- Ⓐ Sleep indicator
- Ⓑ Egg timer indicator
- Ⓒ AM / FM indicator
- Ⓓ Clock digits
- Ⓔ DAB indicator
- Ⓕ FM indicator
- Ⓖ Two line text display

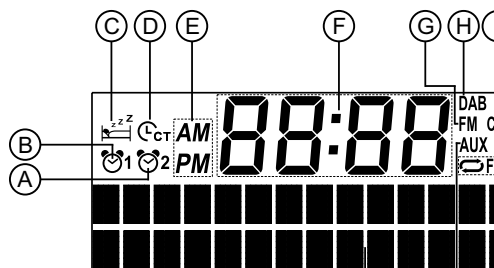

## Installing batteries

1. Position the radio face down on a soft surface.
2. Remove the catch as shown and lift out the battery cover.
3. Insert 2 x “ D “ size/UM-1/LR20 batteries.
4. Replace the battery cover and catch.
5. Reduced power, distortion, a “ stuttering “ sound are all signs that the batteries may need replacing. The batteries should be replaced when “Low Battery” shown on the display.
6. If the radio is not to be used for any extended period of time, it is recommended that the batteries are removed from the radio.

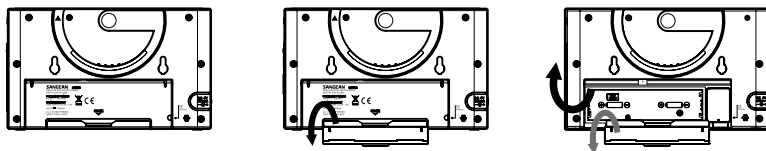

## Using the AC adaptor (not supplied)

GB

1. Remove the rubber cover of DC in socket on the left hand side of your radio.
2. Insert the adaptor plug into the DC socket.
3. Plug the adaptor into mains socket outlet. Whenever the adaptor is used, the batteries are automatically disconnected.

The AC adaptor should be disconnected from the mains supply and the radio when not in use.

### **Note:**

**For safety purpose, DO NOT use AC adaptor in the shower room. Use the batteries only.**

## Setting the clock

### Automatically updating the clock

1. Press and hold the Info/Menu button.
2. Press the Tuning up/down button until 'System' shown on the display, then press the Select button to enter the setting.
3. Press the Tuning up/down button until 'Time' shown on the display., then press the Select button to enter the setting.
4. Press the Tuning up/down until 'Auto Update' shown on the display, press the Select button to enter the setting.
5. Press the Tuning up/down to choose an update option from 'Update from any', 'Update from DAB', 'Update from FM' or 'No update' as required. Press the Select button to confirm your choice. The radio will exit to previous menu display.

### Setting the clock format

1. Press and hold the Info/Menu button.
2. Press the Tuning up/down button until 'System' shown on the display, then press the Select button to enter the setting.
3. Press the Tuning up/down button until 'Time' shown on the display, then press the Select button to enter the setting.
4. Press the Tuning up/down until 'Set 12/24 hour' shown on the display, Press the Select button to enter the setting.
5. Press the Tuning up/down to choose a clock format from 'Set 12 hour' or 'Set 24 hour' as required. Press the Select button to confirm your choice

## Manually setting the clock

1. Press and hold the Info/Menu button.
2. Press the Tuning up/down button until 'System' shown on the display, then press the Select button to enter the setting.
3. Press the Tuning up/down button until 'Time' shown on the display, then press the Select button to enter the setting.
4. Press the Tuning up/down button until 'Set Time/Date' shown on the display. Press the Select button to enter the setting. The digit will flash.
5. Press the Tuning up/down until the correct hour is shown on the display. Press the Select button to enter the selection. The minute digit will start flashing.
6. Press the Tuning up/down until the correct minute is shown on the display. Press the Select button to enter the selection. The day digit will then flash.
7. Then you will be asked to adjust month and year using the steps previously described. 'Time Saved' will show on the display when the clock setting is completed.



## Operating your radio - DAB

1. Press the Power button to switch on your radio. The display will show "Welcome to Digital Radio" for a few seconds.
2. If this is the first time the radio is used, scan of the Band III DAB channels will be carried out. The display will show "Welcome to DAB". If the radio has been used before the last used station will be selected.
3. During the scanning process, as new stations are detected the station counter on the right hand side of the display will increase and stations will be added to the list. The lower line of the display shows a bar-graph indicating progress of autotune.
4. When the scanning is completed the first station (in numeric-alpha order 0...9...A....Z) will be selected.
5. If the station list is still empty after the scan, your radio will show "No DAB Station" for a moment.
6. If no signals are found it may be necessary to relocate your radio to a position giving better reception.

## Selecting a station - DAB

GB

1. The top line of the display shows the name of the station currently selected.
2. Press the Tuning Up/Down buttons to scroll through the list of available stations.
3. Press and release the Select button to select the station. The display may show “Now tuning...” while your radio finds the new station.
4. Adjust the Volume up or Down buttons to set the sound level as needed.

### **Note:**

If after selecting a station the display shows “Service not available “. It may be necessary to relocate your radio to a position giving better reception.

## Secondary services - DAB

1. Certain radio stations have one or more secondary services associated with them. If a station has a secondary service associated with it the display will show “>>” next to the station name on the station list. The secondary service will then appear immediately after the primary service as you press the Tuning Up button.
2. Press the Select button to select the station.

## Display modes - DAB

Your radio has seven display modes:-

1. Press the Info button to cycle through the various modes.

- |                           |  |
|---------------------------|--|
| a. Scrolling text         | Displays scrolling text messages such as artist/track name, phone in number etc. |
| b. Program Type           | Displays the type of station being listened to e.g. Pop, Classic, News etc.      |
| c. Multiplex Name         | Displays the name of DAB multiplex to which the current station belongs.         |
| d. Time and date          | Displays the current the time and date.  |
| e. Frequency              | Displays the frequency of the DAB multiplex for the station listened to.         |
| f . Bit rate & audio type | Displays the digital bit rate & audio type for the station being listened to.    |
| g. Signal Strength        | Displays a graph showing the signal strength for the station being received.     |

## Finding new stations - DAB

GB

As time passes new stations may become available. To allow the radio to find the available stations, it is recommended to carry out a full scan of the entire DAB Band III frequencies.

1. With the radio switched on and in DAB mode, press and hold the Info/Menu button to enter the setting.
2. Press the Tuning up/down button until 'Full Scan' shown on the display. Press Select button to carry out a full scan. The display will show "Scanning..." and your clock radio will perform a scan of the Band III DAB channels. As new radio stations are found the station counter on the left hand side of the display will increase and the radio stations will be added to the list stored in the radio.

## Manual Tuning - DAB

Manual tuning allows you to tune directly to the various DAB Band III channels. Note that DAB stations are located in the range of 5A-13F.

1. Press and hold the Info/Menu to enter the setting.
2. Press Tuning up/down button until “Manual tune” shown on the display. Press the Select button to enter the setting.
3. Press either Tuning Up/Down buttons to select the required DAB channel.
4. Press the Select button to select the required DAB channel. The clear unfilled rectangle indicates the minimum signal level required for satisfactory reception. The signal strength bar will go up and down showing the changing signal strength as you adjust the telescopic aerial on your radio.
5. When a DAB signal is found, the display will show the name of the DAB multiplex. Any new radio stations found will be added to the list stored in the radio.
6. Press and release the Select button to return to the normal DAB tuning mode.

## Dynamic Range Control settings - DAB

GB

Dynamic Range Control (also known as DRC) can make quieter sounds easier to hear when your radio is used in a noisy environment.

1. Press the Power button to switch on your radio.
2. Press and hold the Info/Menu button.
3. Press the Tuning Up/Down buttons until the display shows “DRC value”.
4. Press the Select button to enter the setting.
5. Press the Tuning Up/Down buttons to select the required DRC setting (the default is 0).  
DRC 0 - DRC is switched off, Broadcast DRC will be ignored.  
DRC 1 - DRC is set as sent by broadcaster.  
DRC 1/2 - DRC level is set to 1/2 that sent by broadcaster.
6. Press the Select button to confirm the setting. The display will return to normal tuning mode.

### **Note:**

Not all DAB broadcasts are able to use the DRC function. If the broadcast does not support DRC, then the DRC setting in the radio will have no effect.

## Manual Tuning- FM

1. Press the Power button to switch on your radio.
2. Press the Band button to select the FM band. Fully extend the wire antenna.
3. Press the Select button repeatedly until the display shows “Manual tune < >”.
4. Press either the Tuning Up or Down buttons to tune to a station. The frequency will change in steps of 50kHz. Pressing and holding one of the buttons will advance the frequency selection several times each second.
5. When the end of the waveband is reached the radio will recommence tuning from the opposite end of the waveband.
6. Adjust the Volume control to the required setting.
7. To cancel the Manual Tune option, press and release the Select button again so that the display shows “Auto tune < >”.

## Auto tuning - FM

GB

1. Press the Power button to turn on the radio.
2. Press the Band button to get required waveband, then extend the FM wire antenna located in the battery compartment to get best reception.
3. Press the Select button repeatedly until 'Auto tune <>' shown on the display.
4. Press the Tuning Up button. Your radio will scan from the currently frequency direction upwards and will stop scanning when it finds a station of sufficient strength.
5. The display will show the frequency of the signal which has been found. If RDS information is available, after a few seconds the display will show the radio station name. The display will also show "St" and "RDS" on the upper line if the station is received with stereo and RDS information.
6. Press the Tuning Down button to scan the FM band in a downwards direction (high frequency to low frequency).
7. When the end of the waveband is reached your radio will recommence tuning from the opposite end of the waveband.
8. Adjust the Volume control to the required setting.



## Scan sensitivity setting

Your radio will normally scan for FM broadcasts which are strong enough to give good reception. However, you may wish the Auto-scan function to also be able to find weaker signals, possibly from more distant radio transmitters. Your radio includes a local / distant option for the Auto-scan function.

1. Press and hold Info/Menu button to enter the setting.
2. Press the Tuning up or down button until 'FM Scan Zone' shown on the display. Press Select to enter the setting.
3. Press the Tuning Up or down to select to scan either local or distant radio stations. The Distant option will allow the radio to find weaker signals when scanning.
4. Press the Select button to confirm your setting. The Local or Distant setting is stored in the radio and remains in force until changed or until a system Reset.

### **Note:**

The initial setting (out of the box, or after a System Reset) causes the radio to ignore weaker (or more distant) signals.

## Display modes - FM

In FM mode the bottom line of the display can be set any of four display options.

GB

1. Press the Info button to cycle through the various options.
  - a. Radio text Displays scrolling text messages such as artist/track name, phone in number etc.
  - b. Program Type Displays the programme information for the station being listened to e.g. Pop, Classic, News, etc.
  - c. Time and date Displays the current time and date.
  - d. Frequency Displays the frequency of the station being listened to.

### Note:

These FM mode information displays are only available when the radio is able to receive RDS information from the broadcaster.

## Presetting stations - DAB and FM

There are 4 memory presets for each of the two wavebands.

1. Press the Power button to switch on your radio.
2. Tune to the required station as previously described.
3. Press and hold the required Preset button until the display shows, for example, "Preset 1 stored". The station will be stored under the chosen preset button. Repeat this procedure for the remaining presets.
4. Stations stored in the presets may be overwritten by following the above procedure.

## Recalling a preset - DAB and FM

1. Press the Power button to switch on your radio.
2. Select the required waveband.
3. Momentarily press the required Preset button. Your radio will then tune to the station stored in preset memory.

## Sleep function – Auto Off

The sleep timer will automatically switch off your radio after a preset time has elapsed.

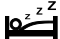
1. Press and hold the Info/Menu button.
2. Press the Tuning up/down button until 'System' shown on the display. Press the Select button to enter the setting.
3. Press the Tuning up/down button until 'Sleep' shown on the display. Press the Select button to enter the setting. The display will cycle through the available sleep times in the order of Sleep off-15-30-45-60-90. Release the button when the required sleep time appears in the display. Press the Select button to confirm the setting. The symbol  will appear in the display and the radio will play the last station selected.
4. To terminate the sleep function before reaching the preset time, follow the procedure above and select 'Sleep Off'. Then the function can be turned off.

## Egg timer (timer function)

GB

1. Press and hold the Info/Menu button.
2. Press the Tuning up/down button until 'System' shown on the display. Press the Select button to enter the setting.
3. Press the Tuning up/down button until 'Egg timer' shown on the display. Press the Select button to enter the setting and the display will appear  on the display.
4. Press the Tuning up/down button to select required time. Press the Select button to confirm the setting.  
The buzzer will sound for 3 minutes when it reaches the period of time which you have set. Press Power button to turn the buzzer off.

To turn off the Egg timer before the time is up, follow the previous timer setting procedure and set the timer to zero. Then the timer setting can be turned off before the time is up.

## Software version

The software display cannot be altered and is just for your reference.

1. To view the software version on the display press and hold the Info button.
2. Repeatedly press the Tuning Up/Down button until 'System' shown on the display. Press the Select button to enter the setting
3. Repeatedly press the Tuning up/down until 'SW version' shown on the display. Press the Select button to confirm the option. The version number is then shown on the display. Press the Info button to the normal tuning mode.

## System reset

If your radio fails to operate correctly, or some digits on the display are missing or incomplete carry out the following procedure.

1. Press and hold down Info button.
2. Repeatedly press the Tuning Up/Down buttons until 'System' shown on the display press the Select button to enter the setting.
3. Press the Tuning up/down button until 'Factory Reset' shown on the display, then press the Select button to enter the setting. If you wish to perform the reset operation, press the Select button once again. A full reset of your radio will be performed. All presets and station lists will be erased.
4. After a system reset a scan of the DAB band will be performed. In case of malfunction due to electrostatic discharge, reset the product (reconnection of power source may be required) to resume normal operation.

## Software upgrade

Software updates for your radio may be available in the future.

As software updates become available software and information on how to update your radio can be found at:

<http://sg.sangean.com.tw/first/first.asp>

<http://www.sangean.eu/first/first.asp>

[www.sangean.com.au](http://www.sangean.com.au).

For more information, please contact our Head Office by sending email to [info@sangean.com](mailto:info@sangean.com)

1. Press and hold the Info/Menu button to enter the setting in any wave band.
2. Press the Tuning control until 'System' shown on the display.  
Press the Select button to enter the setting.
3. Press the Tuning up/down button until 'Software Upgrade' shown on the display. Press the Select button to enter the setting.  
The default setting is 'NO'. Otherwise, press the Tuning control to choose 'YES' and press the Tuning control to select the option.  
The display will show 'Waiting for PC wizard'.
4. Using the micro USB cable (not supplied) to connect the USB socket in the battery compartment and your PC. Follow the procedure stated on your PC screen and the unit will upgrade automatically.

### **Note:**

Please use adapter (not supplied) as main power when upgrading software.

## Emergency buzzer

To activate Emergency buzzer, press Emergency buzzer button. Press the button again to switch off the buzzer.

## Torch

Press the torch  button to turn on the torch.

### Note:

The torch won't turn off automatically. To turn off the torch, press torch button again.

## Multi-purpose handle

Using the multi-purpose handle, you may hang or carry the radio when not used in bathroom.

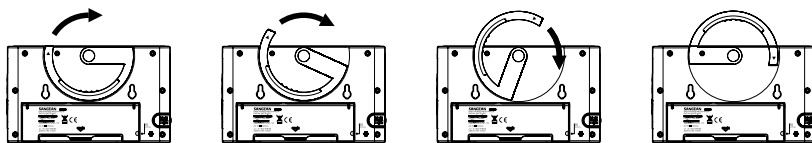

## Bracket

You may install the supplied bracket on the wall with the help of the double sides tape back side to hang the radio.

GB

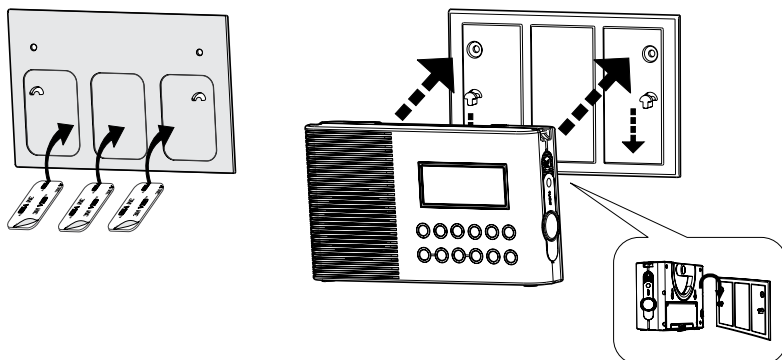
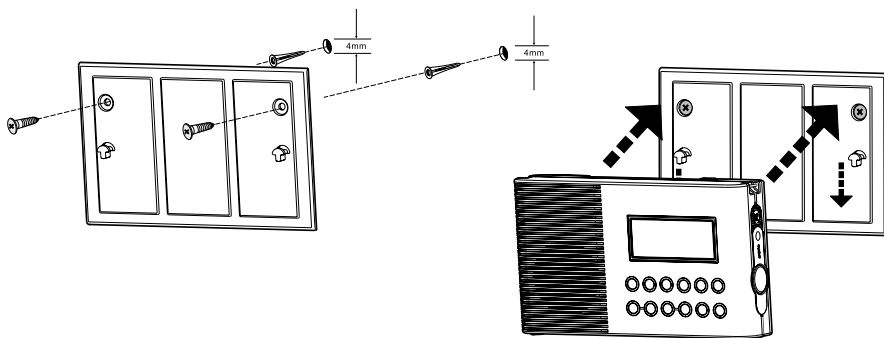



## Carrying strap

Using the supplied carrying strap, you may hang or carry the radio when not used in bathroom.

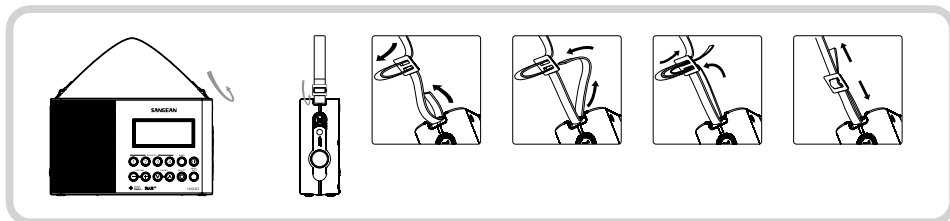

## Power requirements

Mains via AC adaptor (not supplied)

INPUT: 100-240V~ 50/60HZ OUTPUT: DC 5V/600mA

GB

Batteries: 2 x UM1 ( D size, LR20 )

Battery Life:

Approx. 120 hours of listening for 4 hours a day at normal volume using alkaline batteries.

Frequency Coverage:

FM 87.50 – 108 MHz

DAB+ (BAND III): 5A-13F



*If at any time in the future you should need to dispose of this product please note that: Waste electrical products should not be disposed of with household waste. Please recycle where facilities exist. Check with your Local Authority or retailer for recycling advice. (Waste Electrical and Electronic Equipment Directive)*